



GILPIN COUNTY COMMUNITY CENTER

250 Norton Drive, Gilpin County, CO 80403

Grand Opening - May 31, 2003

The Gilpin County Community Center opened its doors on May 1, 2003 to the Peak-to-Peak community of Gilpin County. This 43,000 ft² state-of-the-art facility is a unique project, shaped by its rural mountain setting and the gaming impact funds which made its construction possible. Nestled into the high-altitude landscape, this building will be the host of an increasing number of community-oriented activities.



Fast Facts

building size	43,000 square feet
ground breaking	August, 2000
project completion	May, 2003
total estimated cost	\$8.5 million
funding	100% gaming impact funds

One of the most unique features of

the facility is the Myrtha Pool system. This Italian design is

not only beautiful, but durable and maintenance friendly as well. From the efficient operating system to the fun water features and slide, these pools are truly a highlight of the facility.

The facility will serve a resident county population of 4,700 as well as surrounding neighbors in the Peak-to-Peak region with recreational and cultural programs and events. The staff of Parks & Recreation invites you to join us for an art class, a volleyball game or an afternoon of fun at the swimming pools!



The gymnasium is able to accommodate either one or two full-court games at a time.



The Lap Pool will enable us to offer many aquatics adventures from lap swimming to scuba diving.

Fast Facts

lap pool	
lanes	6
length	25 yards
volume	176,517 gallons
depth	3' - 12'
temperature	82 degrees F
fun features	diving board handicap lift starting blocks

Fast Facts

gymnasium	
size	8,091 square feet
basketball	6 back-boards 3 full court set-ups
volleyball	in-floor inserts, 3 full court set-ups
fun features	motorized curtain electronic scoreboards floating hardwood floor



The Activities Pool contains a figure-eight slide, tumble-buckets, a zero-depth entry and other fun water features sure to bring a smile and a splash!

activities pool

volume	35,989 gallons
depth	3' - 4'6"
temperature	86 degrees F

Gilpin County Parks & Recreation
250 Norton Drive, Gilpin County, CO 80403 p: (303) 582-1453
f: (303) 582-5404 e-mail: gcrec@co.gilpin.co.us





GILPIN COUNTY COMMUNITY CENTER

250 Norton Drive, Gilpin County, CO 80403

Grand Opening - May 31, 2003

Upper Level

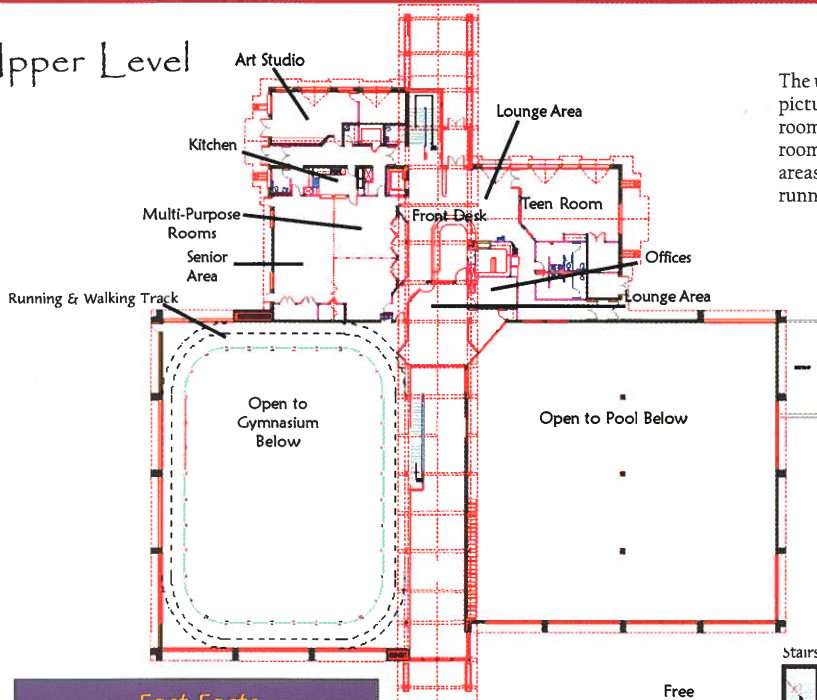

The upper level of the community center, pictured left, includes an art studio/wet crafts room, senior area, teen room, multi-purpose rooms, kitchen, reception area, two lounge areas for the public, staff offices, and the running/walking track which is 1/16 of a mile.

The lower level of the community center, pictured below, contains the gymnasium, fitness studio, free weights area, cardio area, activities pool with water slide and other play features, lap pool with diving board, and locker rooms. The south end of the cardio area frames the surrounding landscape with a full wall of windows, allowing natural light to filter into the area.

Fast Facts

- cardio area**
- size 2,158 square feet
- equipment Magnum, KOS
- 4 treadmills
- 3 recumbant bikes
- rowing machine
- 3 elliptical trainers
- circuit weights
- free weights room**
- size \$16 square feet
- equipment Magnum, KOS
- cable cross-over
- 2 bench presses
- 3 free wt. benches
- bicep curl bench
- pull-up bar
- 4 weight bars
- 1 leg press
- sit-up benches
- squat machine
- dumb-bells

Lower Level

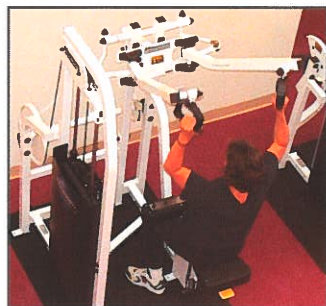
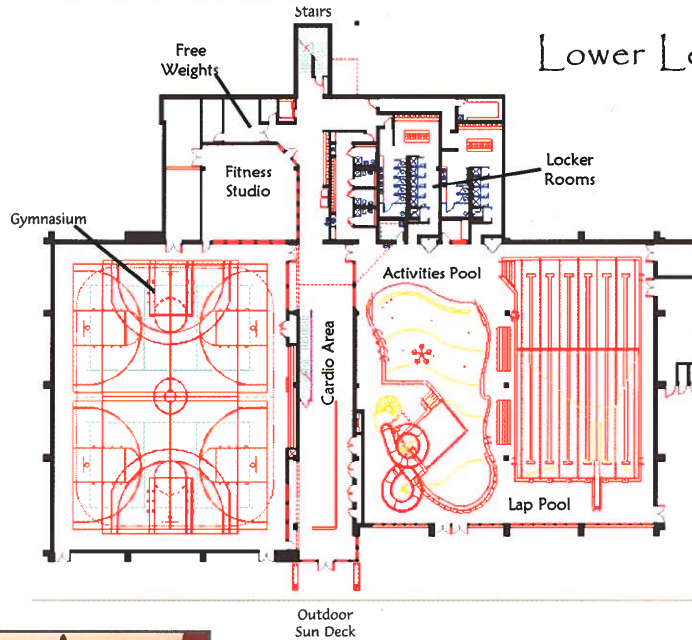

Fast Facts

- indoor running track**
- lanes 2
- distance 1/16 mile
- special features view overlooking gymnasium to the inside, and beautiful views to the outside landscape through windows on the south side and west walls.



Gilpin County Parks & Recreation

250 Norton Drive, Gilpin County, CO 80403 p: (303) 582-1453

f: (303) 582-5404 e-mail: gcrec@co.gilpin.co.us